

Office of The Williams County Engineer

Todd J. Roth, P.E., P.S.

troth@wmscoengineer.com

ADDENDUM NO. 1

Date of Addendum: March 29, 2019

2019 Asphalt Spot Paving, Project #5-2019

Bid Date: , 2019

TO ALL BIDDERS:

The Following Changes Have Been Made To The Bidding Documents:

Additional Work Has Been Added To The Williams County Section.

Item 00300 Bid Form Has Been Changed

Project Manual Has Been Updated

The Estimate Has Been Increased to \$960,148.70

The Location Map Has Been Revised

On line documents will be revised at: <http://www.wmscoengineer.com/bidprojects.asp>, and changes will be sent to plan holders via email.

Please advise this office if you have questions concerning the Addendum.

Thank you.

Respectfully,

ENGI 

Todd J. Roth, P.E., P.S.
Williams County Engineer

OFFICIAL BID FORM

Item 00300

**Project #5-2019
2019 Asphalt Spot Paving**

Williams County, Ohio

Williams County Engineer's Office
12953 County Road G
Bryan, Ohio 43506
419-636-2454
Fax 419-636-8687
Todd J. Roth, P.E., P.S.
email: troth@wmscoengineer.com

Date: 3/12/18 Revised: 3/28/19 **As Revised By Addendum 1**
Prepared By: Cium, Waterston
Revised By:

Bid Date: Thursday, April 4, 2019 @ 10:30 A.M.

Bid Item	Item	Name	Unit	Quantity	Unit Price	Cost
WILLIAMS COUNTY WORK - SPOT PAVE						
County Road M.75 & M.50, TR 1 to CR 6, 8129.1' x 19.5' x 1.50" and 9289.1' x 6.0' x 1.25"						
1a	SS823	Asphalt Concrete Surface Course-Light, Type 1 PG-64-22* (448)	CY	949.00		
1b	614	Maintenance of Traffic - Includes Temp Centerline (Tape) As Needed	LS	1.00		
1c	103	Contract Performance Bond	LS	1.00		
1d	624	Mobilization	LS	1.00		
County Road 6, SR 34 to SR 107, 4833.8' x 20.0' x 1.50" and 9243.2' x 6.0' x 1.25"						
2a	SS823	Asphalt Concrete Surface Course-Light, Type 1 PG-64-22* (448)	CY	662.00		
2b	614	Maintenance of Traffic - Includes Temp Centerline (Tape) As Needed	LS	1.00		
2c	103	Contract Performance Bond	LS	1.00		
2d	624	Mobilization	LS	1.00		
County Road D & 4.50 & F.50 & 5, SR 49 to SR 34, 4074.0' x 20.0' x 1.50" and 6864.0' x 6.0' x 1.25"						
3a	SS823	Asphalt Concrete Surface Course-Light, Type 1 PG-64-22* (448)	CY	536.00		
3b	614	Maintenance of Traffic - Includes Temp Centerline (Tape) As Needed	LS	1.00		
3c	103	Contract Performance Bond	LS	1.00		
3d	624	Mobilization	LS	1.00		
County Road 7 & C, CR 7 to SR 576, 3282.50' x 20' x 1.50" and 6236.7' x 6.0' x 1.25" and 490' x 19' x 0.50" Scratch						
4a	SS823	Asphalt Concrete Surface Course-Light, Type 1 PG-64-22* (448)	CY	500.00		
4b	614	Maintenance of Traffic - Includes Temp Centerline (Tape) As Needed	LS	1.00		
4c	103	Contract Performance Bond	LS	1.00		
4d	624	Mobilization	LS	1.00		
County Road 20, CR C to TR C.50, 2332.2' x 18.5' x 1.75"						
5a	SS823	Asphalt Concrete Surface Course-Light, Type 1 PG-64-22* (448)	CY	233.00		
5b	614	Maintenance of Traffic - Includes Temp Centerline (Tape) As Needed	LS	1.00		
5c	103	Contract Performance Bond	LS	1.00		
5d	624	Mobilization	LS	1.00		
WILLIAMS COUNTY WORK - ADDENDUM #1						
County Road 21/N, Just South of CR 1.25 (Lockport Bridge) Rough ride on curve, 325' x 22' Wide						
6a	SS823	Asphalt Concrete Surface Course-Light, Type 1 PG-64-22* (448), 1-1/2"	CY	33.10		
6b	SS823	Asphalt Concrete Intermediate Course-Medium, Type 1 PG-64-22* (448), 2"	CY	44.13		
6c	254	Pavement Planing Full Depth Asphalt (As Directed, 3" to 5")	SY	795.00		
6d	614	Maintenance of Traffic - Includes Temp Centerline (Tape) As Needed	LS	1.00		
6e	103	Contract Performance Bond	LS	1.00		
6f	624	Mobilization	LS	1.00		

OFFICIAL BID FORM

Item 00300

		County Road D, Just West of CR 12 (Bridge Approaches by Farrells Lawn & Garden) 70' x 25' Wide				
7a	SS823	Asphalt Concrete Surface Course-Light, Type 1 PG-64-22* (448), 2"	CY	10.80		
7b	254	Pavement Plaining Full Depth Asphalt (As Directed, 2" to 3")	SY	195.00		
7c	614	Maintenance of Traffic - Includes Temp Centerline (Tape) As Needed	LS	1.00		
7d	103	Contract Performance Bond	LS	1.00		
7e	624	Mobilization	LS	1.00		
			Williams County Sub Total			
CENTER TOWNSHIP WORK - SPOT PAVE						
Twp Rd 10, At Bridge Replacement, Between SR 34 and CR E, 200' x 16' x 1.5" Surface & Patch/Level on Bridge Deck						
8a	448	Asphalt Concrete Patch/Level-Medium, Type 1 PG-64-22*	CY	14.81		
8b	449	Asphalt Concrete Surface Course-Medium, Type 1 PG-64-22*	CY	14.81		
8c	614	Maintenance of Traffic	LS	1.00		
8d	624	Contract Performance Bond	LS	1.00		
8e	624	Mobilization	LS	1.00		
Krohn's Subdivision, 4487.24' x 18.7' Ave. x 0.1" Thin-Lay Surface						
9a	Special	Thinlay Asphalt Concrete Surface, Type MED, As Per Plan	CY	258.57		
9b	614	Maintenance of Traffic	LS	1.00		
9c	624	Contract Performance Bond	LS	1.00		
9d	624	Mobilization	LS	1.00		
9e	254	Butt Joint at SR 576	LS	1.00		
			Center Township Sub Total			
SUPEIOR TOWNSHIP WORK - SPOT PAVE						
Township Road 12.50, Between SR 107 and CR N, 11,038.7' x 20.6' Ave x 1.5" Surface						
10a	448	Asphalt Concrete Surface Course-Medium, Type 1 PG 64-22	CY	1084.00		
10b	254	Pavement Plaining Full Depth Asphalt (As Directed, 4" to 6")	SY	133.33		
10c	301	Asphalt Concrete Base, PG 64-22 (As Directed, 4" to 6")	CY	22.22		
10d	254	Butt Joints at Turnpike	LS	2.00		
10e	614	Maintenance of Traffic	LS	1.00		
10f	624	Contract Performance Bond	LS	1.00		
10g	624	Mobilization	LS	1.00		
			Superior Township Sub Total			

WILLIAMS COUNTY WILL PRODUCE A FILLABLE BID FORM FOR POSTING ON WMS CO ENGINEER WEB PAGE

Total Base Bid

The above quantities are estimated amountys only, the fnial quantities may be more or less that listed above. The Owner will pay for the actual amount of materials delivered and placed at the work site at the unit price listed above. ODOT asphalt index will NOT apply to this project. Work above includes tack coat on asphalt overlays including work where tack is not specifically listed.

SUBMITTED BY:

BIDDER

BIDDERS SIGNATURE

Date

END OF ITEM

OFFICE OF THE COUNTY COMMISSIONERS

WILLIAMS COUNTY, OHIO

PROJECT MANUAL

2019 ASPHALT SPOT PAVING

WILLIAMS COUNTY PROJECT #5-2019

COMMISSIONERS:

**Terry N. Rummel
Lewis D. Hilkert
Brian A. Davis**

COUNTY ENGINEER:

Todd J. Roth, P.E., P.S.

Date of Letting: April 4, 2019 At 10:30 A.M. Local Time

ENGINEER'S ESTIMATE: ~~\$908,934.35~~ **\$960,148.70**



CONTRACTOR'S NAME AND ADDRESS:

Submitted by: _____

Address: _____

City: _____

State: _____ Zip Code: _____

Phone: _____ Fax: _____

Email: _____

Purchase Order Number: _____

As Revised By Addendum 1

WILLIAMS COUNTY, OHIO

 2019 SPOT PAVING





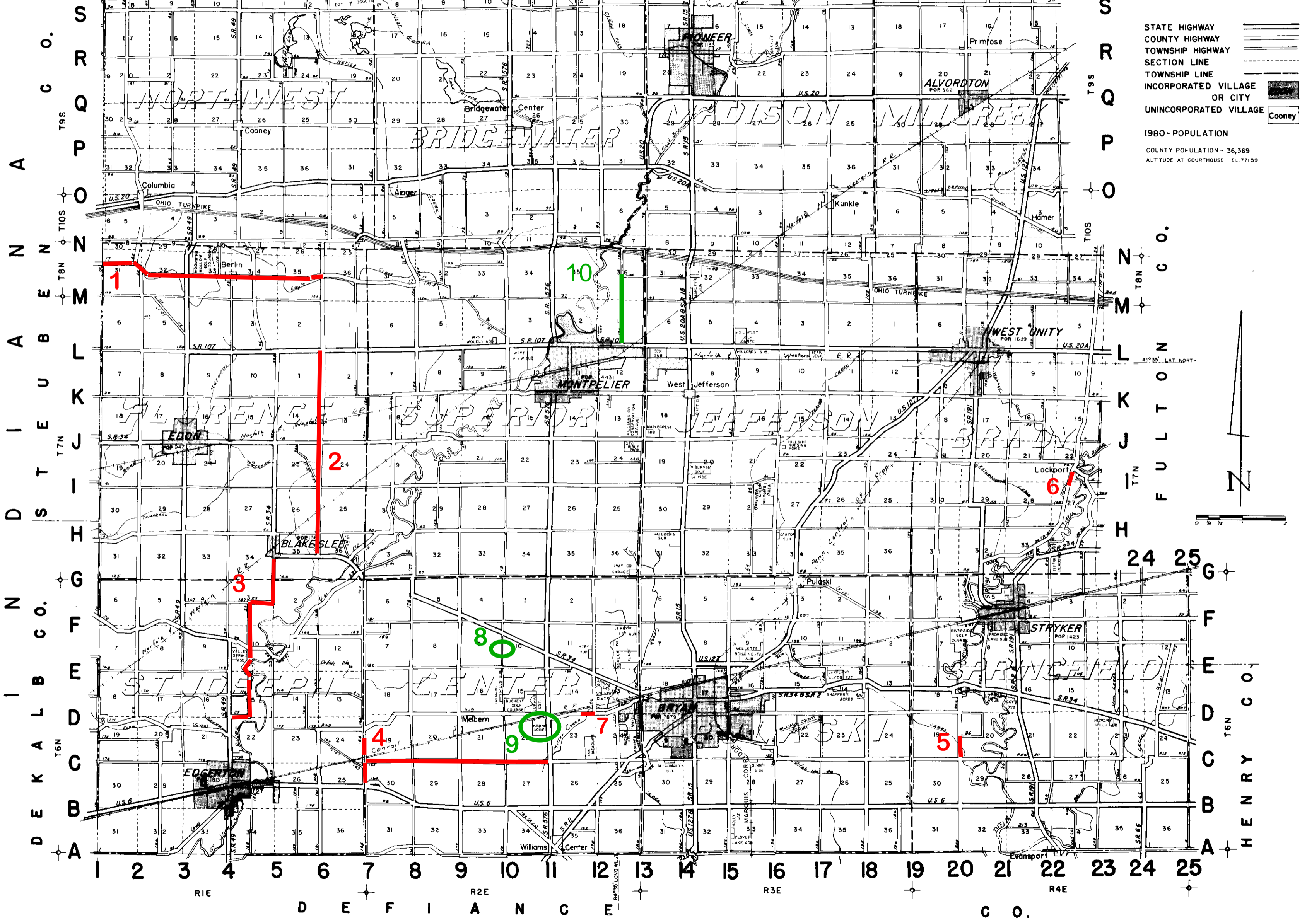

 TOWNSHIP

H I L L S D A L E C O. M I C H

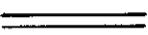
R4W R3W R2W R1W

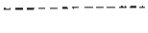
2 3 4 5 6 7 8 9 10 11 12 13 14 15 16 17 18 19 20 21 22



STATE HIGHWAY 
 COUNTY HIGHWAY 
 TOWNSHIP HIGHWAY 
 SECTION LINE 
 TOWNSHIP LINE 
 INCORPORATED VILLAGE OR CITY 
 UNINCORPORATED VILLAGE  Cooney

1980 - POPULATION
 COUNTY POPULATION - 36,369
 ALTITUDE AT COURTHOUSE EL. 7159

