

2021 Asphalt Paving Program, Project #5-2021

TOWNSHIP

WILLIAMS COUNTY, OHIO

2021 PAVING
SPOT PAVING
WMSCO

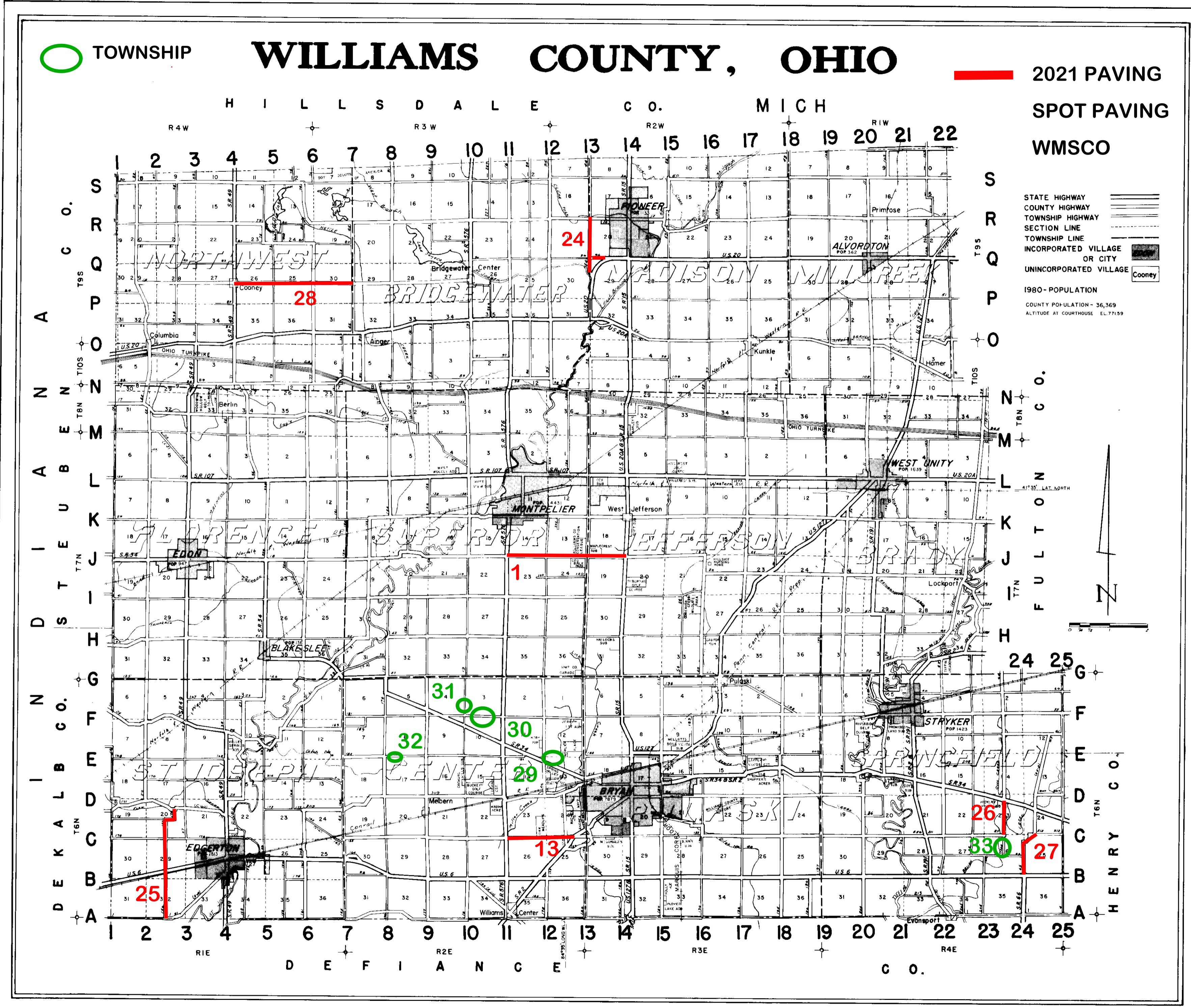

STATE HIGHWAY
 COUNTY HIGHWAY
 TOWNSHIP HIGHWAY
 SECTION LINE
 TOWNSHIP LINE
 INCORPORATED VILLAGE
 OR CITY
 UNINCORPORATED VILLAGE

1980 - POPULATION
 COUNTY POPULATION - 36,369
 ALTITUDE AT COURTHOUSE EL. 771.59

