

April 3, 2017

Board of Williams County Commissioners
One Courthouse Square
Bryan, OH 43506

RE: Ditch No. 518, Reitzel, Maintenance Review
Florence Township

Commissioners:

In Accordance with Section 6137.11 of the Ohio Revised Code I hereby request the following changes be made to the permanent maintenance base and assessment roles, through resolution, to Single County Ditch Number 518 Reitzel, in Florence Township.

1. The methods and procedures of the Williams County Engineers Office's Drainage Department to calculate the overall watershed and individual effective benefitted acreage for Ditch No. 518 using the most accurate information available.
2. The total watershed of Ditch No. 518 is updated to 776.36 acres.
3. A Total Effective Benefitted Acreage of 571.24 acres is accepted as the benefit assessment base along with each individual parcel's effective benefitted acreage, as provided in the attached enclosure, as the means for calculating each individual parcel's annual maintenance assessment.
4. For the purposes of the annual maintenance collection, a percentage of the permanent maintenance base is assessed to each individual parcel within Ditch No. 518 Tile's watershed as a rate per effective benefitted acre.
5. A maximum parcel charge of Thirty (30) dollars per effective benefitted acre and a minimum charge of ten (10) dollars per parcel.
6. In accordance with Ohio Revised Code 6137.112, an amount of \$76,000.00 is used in lieu of the original construction cost of Ditch No. 518 as the permanent maintenance base. The amount of \$76,000.00 reflects an estimated cost if Ditch No. 518 were to be constructed today.

7. Any parcel which has been, or will be, receiving a maintenance assessment reduction for the presence of a filter strip along the length of the maintained portion of Ditch No. 518, will have its assessment reduction calculated according to Resolution 10-1032 adopted on December 30, 2010.
8. In accordance with Ohio Revised Code 6137.06, Ditch No. 518 is to contribute a percentage of the total annual charges against the maintenance rotary fund equal to the percentage of Ditch No. 518's watershed acres within the total maintenance watershed acres of the maintenance program. The rotary fund is established to purchase equipment, materials, and labor related to the general maintenance of watercourses under Chapter 6137.

I also request that the changes to the permanent maintenance base and the benefit assessment base take effect and be certified to the Williams County Auditor upon adoption of the resolution.

Respectfully Submitted,

Brian D. Fritsch, P.E.
Williams County Drainage Engineer

encl

Parcel Number	Legal Acres	Watershed Acres	Effective Benefitted Acres	Updated Construction	Effective Benefit Percent	Owner	Owner Addr1	Owner Addr2	Owner City	Owner State	Owner Zip
0710500003000	22.03	1.37	1.08	\$144.13	0.19%	REITZEL JACOB E	12514	COUNTY ROAD 2	EDON	OH	43518
0710500004000	17.51	17.19	13.12	\$1,745.08	2.30%	REITZEL KEITH D JR AND	11542	COUNTY ROAD 2	EDON	OH	43518
0710500005000	120.08	98.77	75.92	\$10,100.45	13.29%	REITZEL KEITH DAVID JR	11542	COUNTY ROAD 2	EDON	OH	43518
0710500006000	80.00	80.00	59.74	\$7,947.17	10.46%	GEARHART LLOYD MACK ETAL	101	ELM	EDON	OH	43518
0710500007000	11.97	11.97	8.67	\$1,153.83	1.52%	GEARHART JAMES D AND	2567	COUNTY ROAD L	EDON	OH	43518
0710500008000	65.95	19.50	9.41	\$1,252.45	1.65%	GEARHART WILLIAM L	2867	COUNTY ROAD L	EDON	OH	43518
07105000010000	0.86	0.57	0.35	\$46.35	0.06%	REITZEL JAMES L D AND	2927	COUNTY ROAD L	EDON	OH	43518
07105000011000	0.61	0.27	0.15	\$20.47	0.03%	RAATZ BRICE	2957	COUNTY ROAD L	EDON	OH	43518
07105000012000	0.62	0.10	0.04	\$10.00	0.01%	BONEWITZ BRAN A AND JAMIE	2991	COUNTY ROAD L	EDON	OH	43518
07105000015000	35.20	5.16	3.11	\$414.25	0.55%	GEARHART WM LEE	2867	COUNTY ROAD L	EDON	OH	43518
07105000016000	31.30	1.36	0.89	\$118.26	0.16%	VOLLMER KENNETH E TRUSTEE	2415	COUNTY ROAD K	EDON	OH	43518
07105000017000	35.00	0.82	0.57	\$76.01	0.10%	MASON CAROL	2588	COUNTY ROAD 2L	EDON	OH	43518
07106000013000	93.14	42.19	31.49	\$4,189.40	5.51%	PATTON TAMRA F AND CHARLES	16010	SMITH	YODER	IN	46798
07106000015000	80.00	44.89	35.00	\$4,656.49	6.13%	CRAWFORD NANCY S(LE) @3	1839	COUNTY ROAD L	EDON	OH	43518
07107000001000	117.95	4.77	3.31	\$440.07	0.58%	GEARHART KIM E AND LAURA I	9630	COUNTY ROAD 750	EDON	OH	43518
07107000011000	2.05	0.19	0.08	\$10.20	0.01%	DWYER TROY A AND KATHLEEN S	11801	COUNTY ROAD 2	EDON	OH	43518
07108000001001	1.39	1.39	0.77	\$102.44	0.14%	REITZEL KENNETH L AND GAIL	2700	COUNTY ROAD L	EDON	OH	43518
07108000001002	1.63	1.63	1.14	\$152.20	0.20%	REITZEL LARUE H	11817	STATE ROUTE 49	EDON	OH	43518
07108000002000	0.93	0.93	0.70	\$92.70	0.12%	SMITH CRYSTAL	2822	COUNTY ROAD L	EDON	OH	43518
07108000003000	5.05	5.05	3.80	\$505.96	0.67%	REITZEL KENNETH L AND GAIL	2700	COUNTY ROAD L	EDON	OH	43518
07108000004000	121.48	121.48	91.76	\$12,207.40	16.06%	REITZEL KENNETH L ETAL	2700	COUNTY ROAD L	EDON	OH	43518
07108000004001	5.11	5.11	3.79	\$504.03	0.66%	REITZEL KENNETH L AND GAIL	2700	COUNTY ROAD L	EDON	OH	43518
07108000004002	4.41	4.41	3.37	\$447.86	0.59%	OSBORN JODY L AND JOSIE K	2692	COUNTY ROAD L	EDON	OH	43518
07108000005000	98.12	89.51	67.85	\$9,026.71	11.88%	GEARHART LLOYD MACK ETAL	101	ELM	EDON	OH	43518
07108000005001	1.88	1.88	1.24	\$164.43	0.22%	WELCH STEVE R AND	2114	COUNTY ROAD L	EDON	OH	43518
07108000006000	14.91	8.15	6.32	\$841.35	1.11%	REITZEL KEITH DAVID JR AND	11542	COUNTY ROAD 2	EDON	OH	43518
07108000008000	80.00	25.90	20.14	\$2,678.93	3.53%	REITZEL KEITH DAVID JR AND	11542	COUNTY ROAD 2	EDON	OH	43518
07108000011000	96.93	59.67	36.96	\$4,917.52	6.47%	ROAN LYLE TRUSTEE	309	HAMILTON	BRYAN	OH	43506
07108000012000	3.14	1.33	1.05	\$139.70	0.18%	STAYNER DOUGLAS T AND	2711	COUNTY ROAD K	EDON	OH	43518
07108000013000	27.43	27.00	20.51	\$2,728.84	3.59%	TAYLOR MILDRED	3579	STATE ROUTE 107	EDON	OH	43518
07108000014000	37.68	37.66	26.44	\$3,517.81	4.63%	MANGES LYLE SCOTT AND	11391	STATE ROUTE 49	EDON	OH	43518
07108000015000	2.00	1.99	1.34	\$178.36	0.24%	ALLOMONG RANDALL C	11407	STATE ROUTE 49	EDON	OH	43518
07108000017000	2.82	2.82	1.68	\$223.28	0.29%	LIVENSARGER STEVEN J	11591	STATE ROUTE 49	EDON	OH	43518
07109000003000	99.31	32.63	23.14	\$3,079.09	4.05%	KAISER ARVILLA R (LE) @(5)	12044	STATE ROUTE 49	EDON	OH	43518
07109000004000	60.00	1.30	0.91	\$121.59	0.16%	DEWIRE LOIS JOAN AND	11612	STATE ROUTE 49	EDON	OH	43518
07109000005000	60.00	0.39	0.26	\$35.11	0.05%	OSBORN ROGER AND MARILYN	11326	STATE ROUTE 49	EDON	OH	43518

Parcel Number	Legal Acres	Watershed Acres	Effective Benefitted Acres	Updated Construction	Effective Benefit Percent	Owner	Owner Addr1	Owner Addr2	Owner City	Owner State	Owner Zip
07109000006000	88.00	2.39	1.61	\$214.35	0.28%	OSBORN ROGER AND MARILYN	11326	STATE ROUTE 49	EDON	OH	43518
County	2716.71	9.31	8.31	\$1,105.63	1.46%	WILLIAMS COUNTY ENGINEER					
Florence Township	223.09	0.29	0.26	\$34.31	0.05%	FLORENCE TWP TRUSTEES					
ODOT	1501.60	5.03	4.93	\$655.79	0.86%	ODOT					
	5967.90	776.36	571.24	\$76,000.00	100.00%						

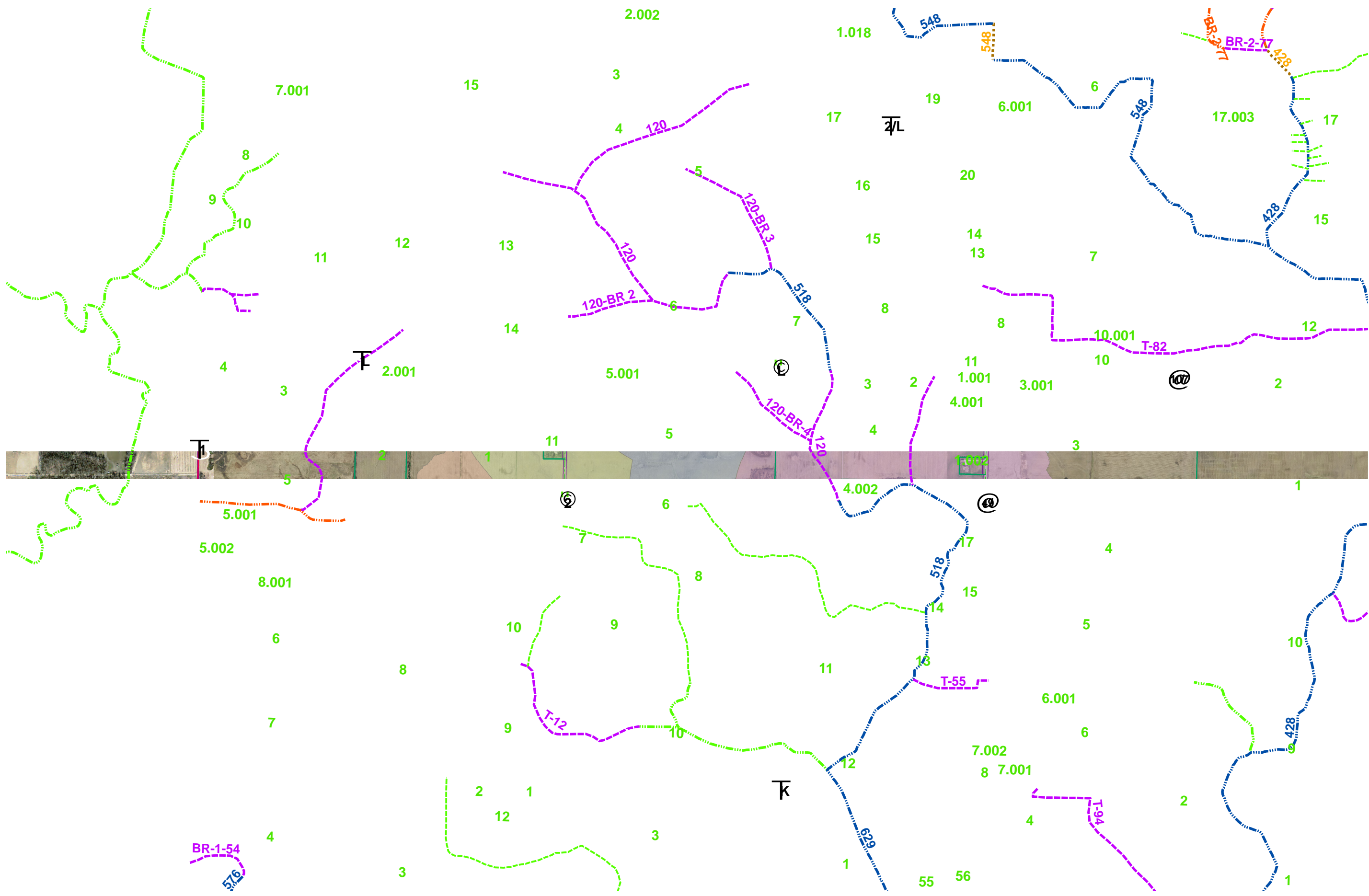

Williams County Drainage

- PM Open Ditches
- PM Drainage Tile
- Tile of Record
- Open Ditch of Record
- Other Drainage
- Other Drainage Tile
- Assumed Flow Path
- Waterbody

Drainage Deductions

Lateral Distance Consideration

- No Deduction
- 10% Deduction
- 20% Deduction
- 30% Deduction
- 40% Deduction

518 Reitzel

