

April 3, 2017

Board of Williams County Commissioners
One Courthouse Square
Bryan, OH 43506

RE: Ditch No. 554, Goebel, Maintenance Review
Saint Joseph Township

Commissioners:

In Accordance with Section 6137.11 of the Ohio Revised Code I hereby request the following changes be made to the permanent maintenance base and assessment roles, through resolution, to Single County Ditch Number 554 Goebel, in Saint Joseph Township.

1. The methods and procedures of the Williams County Engineers Office's Drainage Department to calculate the overall watershed and individual effective benefitted acreage for Ditch No. 554 using the most accurate information available.
2. The total watershed of Ditch No. 554 is updated to 1154.01 acres.
3. A Total Effective Benefitted Acreage of 739.78 acres is accepted as the benefit assessment base along with each individual parcel's effective benefitted acreage, as provided in the attached enclosure, as the means for calculating each individual parcel's annual maintenance assessment.
4. For the purposes of the annual maintenance collection, a percentage of the permanent maintenance base is assessed to each individual parcel within Ditch No. 554 Tile's watershed as a rate per effective benefitted acre.
5. A maximum parcel charge of Twenty (20) dollars per effective benefitted acre and a minimum charge of ten (10) dollars per parcel.
6. In accordance with Ohio Revised Code 6137.112, an amount of \$23,000.00 is used in lieu of the original construction cost of Ditch No. 554 as the permanent maintenance base. The amount of \$23,000.00 reflects an estimated cost if Ditch No. 554 were to be constructed today.

7. Any parcel which has been, or will be, receiving a maintenance assessment reduction for the presence of a filter strip along the length of the maintained portion of Ditch No. 554, will have its assessment reduction calculated according to Resolution 10-1032 adopted on December 30, 2010.
8. In accordance with Ohio Revised Code 6137.06, Ditch No. 554 is to contribute a percentage of the total annual charges against the maintenance rotary fund equal to the percentage of Ditch No. 554's watershed acres within the total maintenance watershed acres of the maintenance program. The rotary fund is established to purchase equipment, materials, and labor related to the general maintenance of watercourses under Chapter 6137.

I also request that the changes to the permanent maintenance base and the benefit assessment base take effect and be certified to the Williams County Auditor upon adoption of the resolution.

Respectfully Submitted,

Brian D. Fritsch, P.E.
Williams County Drainage Engineer

encl

Parcel Number	Legal Acres	Watershed Acres	Effective Benefitted Acres	Updated Construction	Effective Benefit Percent	Owner	Owner Addr1	Owner Addr2	Owner City	Owner State	Owner Zip
0612000007000	29.90	10.42	5.64	\$175.19	0.76%	JC FLEGAL LLC	103	DAIRY	EDGERTON	OH	43517
0612000008000	120.00	51.60	31.02	\$963.62	4.19%	ENTENMAN ARTHUR P	4345	COUNTY ROAD 3	EDGERTON	OH	43517
06120000010000	78.80	36.66	23.24	\$721.81	3.14%	GOEBEL CLAIR AND LAVERNE	2900	COUNTY ROAD C	EDGERTON	OH	43517
06120000016000	40.00	30.28	19.09	\$592.89	2.58%	KIMPEL JERRY	3133	COUNTY ROAD 3	EDGERTON	OH	43517
06128017040000	1.38	0.25	0.16	\$10.00	0.04%	MUEHLFELD SKIPPY AND	3234	COUNTY ROAD C	EDGERTON	OH	43517
06128017041000	44.75	32.90	21.98	\$682.75	2.97%	GOEBEL CLAIR AND LAVERNE	2900	COUNTY ROAD C	EDGERTON	OH	43517
06128017042000	0.57	0.57	0.37	\$11.63	0.05%	BADMAN SCOTT T AND	3036	COUNTY RD C	EDGERTON	OH	43517
06128017043000	0.86	0.85	0.57	\$17.56	0.08%	MINCK ROBERT A AND	3010	COUNTY RD C	EDGERTON	OH	43517
06128017044000	25.48	25.48	16.97	\$527.16	2.29%	EDGERTON DEVELOPMENT INC		PO BOX 734	EDGERTON	OH	43517
06128017044001	4.27	4.27	3.40	\$105.47	0.46%	DARMARC LMTD LIABILITY CO	130	COUNTRY CLUB	BRYAN	OH	43506
06128017044002	4.45	4.45	3.53	\$109.52	0.48%	OREN ELLIOTT PRODUCTS INC	128	VINE	EDGERTON	OH	43517
06128017044003	5.54	5.54	3.99	\$123.90	0.54%	RUBU II LLC	11495A	ST RT 15	MONTPELIER	OH	43543
06128017044004	1.51	1.51	1.00	\$30.95	0.14%	EDGERTON VILLAGE OF		P O BOX 609	EDGERTON	OH	43517
06128017044005	6.00	6.00	4.34	\$134.85	0.59%	T T TECHNOLOGIES INC	118	INDUSTRIAL	EDGERTON	OH	43517
06128017044006	2.46	2.30	1.62	\$50.19	0.22%	STILTNER CHARLES R AND	3123	US HWY 6	EDGERTON	OH	43517
06128017044007	4.72	4.72	3.62	\$112.52	0.49%	OREN ELLIOTT PRODUCTS INC		PO BOX 638	EDGERTON	OH	43517
06128017044008	7.00	7.00	3.90	\$121.25	0.53%	EDGERTON VILLAGE OF		P O BOX 609	EDGERTON	OH	43517
06128017045000	5.00	5.00	3.94	\$122.28	0.53%	RUBU II LLC	11495	ST RT 15 STE A	MONTPELIER	OH	43543
06128017046000	3.21	1.58	1.05	\$32.57	0.14%	STILTNER CHARLES R AND	3123	US HWY 6	EDGERTON	OH	43517
06128017047000	30.93	27.62	18.65	\$579.26	2.52%	EDGERTON VILLAGE OF		P O BOX 609	EDGERTON	OH	43517
06128017047001	6.95	2.18	1.53	\$47.47	0.21%	FARNHAM ANDREW M(*) ETAL	2112	COUNTY ROAD C60	EDGERTON	OH	43517
06128017048000	2.00	0.21	0.15	\$10.00	0.04%	PAHL READY MX CONCRETE I	14586	US HIGHWAY 127 E/W	BRYAN	OH	43506
06128019001000	44.71	20.15	13.99	\$434.65	1.89%	SANDERS MARY L TRUSTEE @(2)	1954	COUNTY ROAD 250	EDGERTON	OH	43517
06128019970000	0.00	1.39	0.00	\$10.00	0.04%	PENNSYLVANIA LINES LLC	1200	PEACHTREE	ATLANTA	GA	30309
06129000001000	80.00	80.00	55.04	\$1,709.43	7.43%	GOEBEL CLAIR AND LAVERNE	2900	COUNTY ROAD C	EDGERTON	OH	43517
06129000002000	79.00	79.00	53.41	\$1,658.95	7.21%	GOEBEL CLAIR AND LAVERNE	2900	COUNTY ROAD C	EDGERTON	OH	43517
06129000002001	1.00	1.00	0.64	\$19.93	0.09%	GOEBEL ANTHONY AND	2652	COUNTY ROAD 250	EDGERTON	OH	43517
06129000003000	25.99	25.99	19.40	\$602.71	2.62%	GOEBEL JAMES G AND ANGELA M	2110	COUNTY ROAD C	EDGERTON	OH	43517
06129000003001	8.49	8.49	5.58	\$173.35	0.75%	GOEBEL ANDREW L	2805	US HIGHWAY 6	EDGERTON	OH	43517
06129000004000	5.55	5.55	4.01	\$124.67	0.54%	LIECHTYS FARM EQUIPMENT		PO BOX #9	ARCHBOLD	OH	43502
06129000005000	38.00	38.00	29.15	\$905.27	3.94%	SANDERS MARY L TRUSTEE @(2)	1954	COUNTY ROAD 250	EDGERTON	OH	43517
06129000006000	25.00	25.00	17.22	\$534.70	2.33%	SANDERS MARY L TRUSTEE @(2)	1954	COUNTY ROAD 250	EDGERTON	OH	43517
06129000007000	27.00	16.28	10.74	\$333.47	1.45%	RADABAUGH JOHN W AND	1778	COUNTY ROAD 250	EDGERTON	OH	43517
06129000008000	0.46	0.46	0.25	\$10.00	0.04%	STARK RONALD	2233	US HIGHWAY 6	EDGERTON	OH	43517
06129000009000	135.54	135.43	83.92	\$2,606.55	11.33%	STARK RONALD AND NANCY	2233	US HIGHWAY 6	EDGERTON	OH	43517
06129000009001	2.00	2.00	1.24	\$38.48	0.17%	STARK BRIAN	2288	COUNTY ROAD 250	EDGERTON	OH	43517

Parcel Number	Legal Acres	Watershed Acres	Effective Benefitted Acres	Updated Construction	Effective Benefit Percent	Owner	Owner Addr1	Owner Addr2	Owner City	Owner State	Owner Zip
06129000010000	40.00	40.00	25.32	\$786.59	3.42%	STARK RONALD R & NANCY L	2233	US HIGHWAY 6	EDGERTON	OH	43517
06129000011000	1.00	1.00	0.63	\$19.50	0.09%	GOEBEL CLAIR AND LAVERNE	2900	COUNTY ROAD C	EDGERTON	OH	43517
06129000012000	49.00	49.00	33.38	\$1,036.81	4.51%	GOEBEL CLAIR AND LAVERNE	2900	COUNTY ROAD C	EDGERTON	OH	43517
06129000013000	5.00	5.00	3.44	\$106.75	0.46%	FABER THANE E AND	2819	COUNTY ROAD 250	EDGERTON	OH	43517
06129000014000	5.24	5.24	3.11	\$96.71	0.42%	PARTIN GENE AND ETHEL M	2925	COUNTY ROAD 250	EDGERTON	OH	43517
06129000014001	1.00	1.00	0.49	\$15.20	0.07%	HICKMAN INDIA R	2853	COUNTY ROAD 250	EDGERTON	OH	43517
06129000015000	3.28	3.28	1.98	\$61.43	0.27%	PARTIN GENE AND ETHEL M	2925	COUNTY ROAD 250	EDGERTON	OH	43517
06129000016000	2.63	2.63	1.26	\$39.07	0.17%	MILLER SARAH L	2979	COUNTY ROAD 250	EDGERTON	OH	43517
06129000017000	2.39	2.39	1.35	\$41.96	0.18%	STUDER KEVIN	333	INDIANA	EDGERTON	OH	43517
06129000018000	10.48	10.48	5.50	\$170.95	0.74%	BEVERLY ROBERT D	2280	COUNTY ROAD C	EDGERTON	OH	43517
06129000019000	78.32	78.32	43.31	\$1,345.26	5.85%	GOEBEL JAMES AND ANGELA M	2110	COUNTY ROAD C	EDGERTON	OH	43517
06129000020000	1.68	1.68	0.94	\$29.07	0.13%	GOEBEL JAMES & ANGELA M	2110	COUNTY ROAD C	EDGERTON	OH	43517
06130000001000	80.00	12.56	5.92	\$183.80	0.80%	SHOLL THOMAS A AND	1621	COUNTY ROAD C	EDGERTON	OH	43517
06130000002000	77.00	14.74	7.96	\$247.26	1.08%	STARK RONALD AND NANCY	2233	US HIGHWAY 6	EDGERTON	OH	43517
06130000003000	40.00	35.09	13.65	\$424.03	1.84%	STARK RONALD R & NANCY L	2233	US HIGHWAY 6	EDGERTON	OH	43517
06130000004000	120.00	19.58	8.29	\$257.56	1.12%	GOZDOWSKI MARK A AND	29058	LIME CITY	PERRYSBURG	OH	43551
06132000001000	1.31	1.31	0.88	\$27.42	0.12%	SANDERS MARY TRUSTEE	1954	COUNTY ROAD 250	EDGERTON	OH	43517
06132000002000	65.69	64.16	41.71	\$1,295.36	5.63%	SANDERS MARY L TRUSTEE @ (2)	1954	COUNTY ROAD 250	EDGERTON	OH	43517
06132000003000	16.23	10.18	6.59	\$204.73	0.89%	RADABAUGH JOHN W AND JODI	1778	COUNTY ROAD 250	EDGERTON	OH	43517
06132000003001	13.41	13.41	9.29	\$288.55	1.26%	RADABAUGH JOHN W AND JODI	1778	COUNTY ROAD 250	EDGERTON	OH	43517
06132000005001	31.86	1.80	1.36	\$42.18	0.18%	EVERETTS CHAD	2534	WILLIAMS DEF CO LINE	EDGERTON	OH	43517
06132000019000	160.00	29.31	20.06	\$623.01	2.71%	WEBER EUNICE A ETAL	10119	DONALD	LEO	IN	46765
06133001003001	66.89	0.97	0.73	\$22.65	0.10%	GOEBEL JAMES G AND ANGELA M	2110	COUNTY ROAD C	EDGERTON	OH	43517
06133001005000	100.00	8.81	5.44	\$169.07	0.74%	MEYER LOUIS J	307	COLE DRIVE	WAPAKONETA	OH	45895
County	2716.71	9.62	7.65	\$237.72	1.03%	WILLIAMS COUNTY ENGINEER					
Edgerton	126.05	5.44	4.34	\$134.80	0.59%	EDGERTON VILLAGE COUNCIL					
Norfolk Southern	710.44	13.16	9.97	\$309.80	1.35%	NORFOLK SOUTHERN COMB RR	ENGINEERING	1200 PEACHTREE	ATLANTA	GA	30309
ODOT	1501.60	7.98	6.47	\$200.98	0.87%	ODOT					
St. Joe Township	203.20	5.78	4.40	\$136.78	0.60%	ST. JOSEPH TWP TRUSTEES					
	7128.94	1154.01	739.78	\$23,000.00	100.00%						

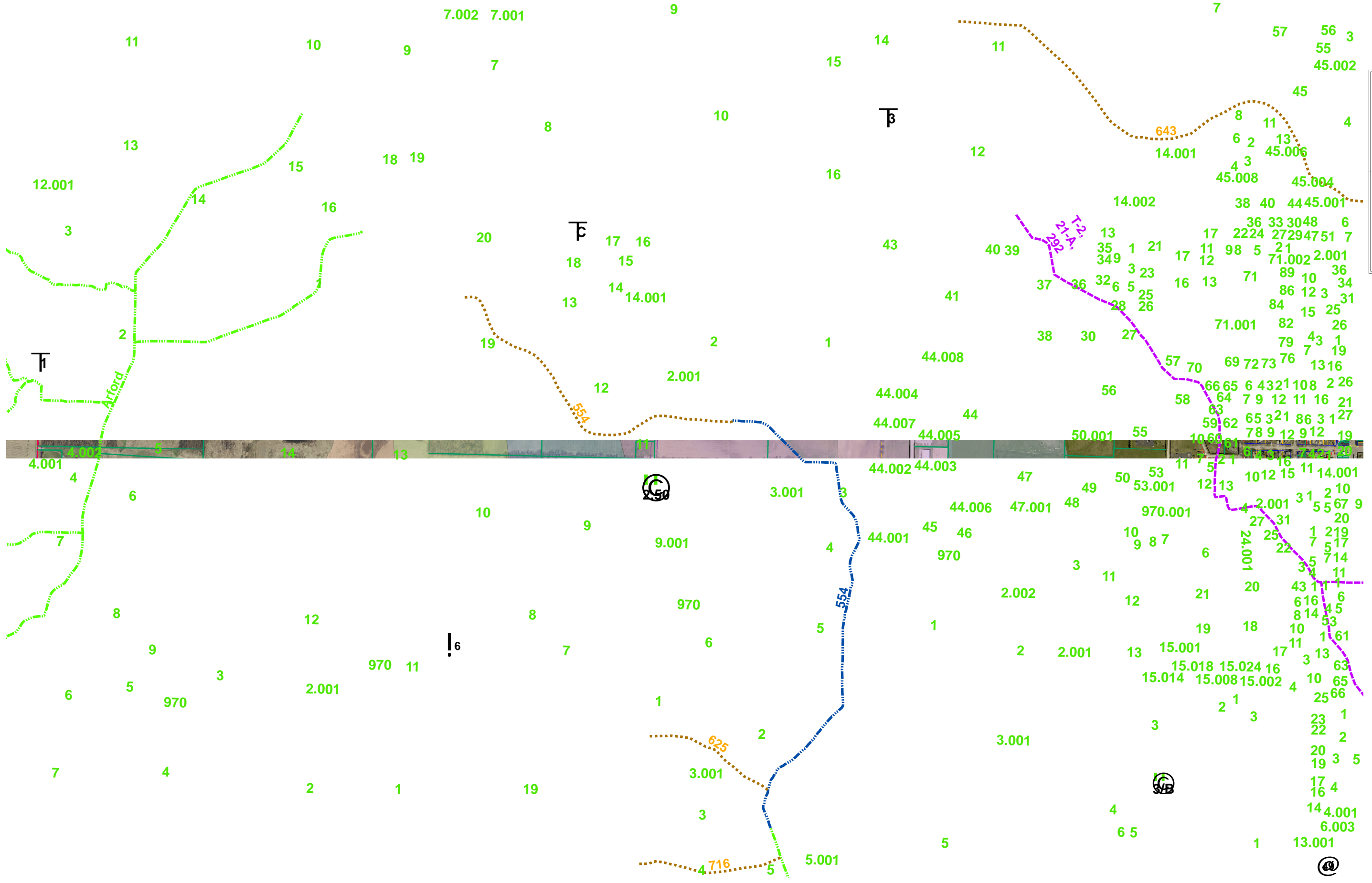

Williams County Drainage

- - - - - PM Open Ditches
- PM Drainage Tile
- - - - - Tile of Record
- - - - - Open Ditch of Record
- - - - - Other Drainage
- - - - - Other Drainage Tile
- — — — — Assumed Flow Path
- Waterbody

Lateral Distance Consideration

- No Deduction
- 10% Deduction
- 20% Reduction
- 30% Reduction
- 40% Reduction

554 Goebel