

April 3, 2017

Board of Williams County Commissioners
One Courthouse Square
Bryan, OH 43506

RE: Ditch No. 576, Lautzenhiser, Maintenance Review
Florence Township

Commissioners:

In Accordance with Section 6137.11 of the Ohio Revised Code I hereby request the following changes be made to the permanent maintenance base and assessment roles, through resolution, to Single County Ditch Number 576 Lautzenhiser, in Florence Township.

1. The methods and procedures of the Williams County Engineers Office's Drainage Department to calculate the overall watershed and individual effective benefitted acreage for Ditch No. 576 using the most accurate information available.
2. The total watershed of Ditch No. 576 is updated to 1558.69 acres.
3. A Total Effective Benefitted Acreage of 1108.77 acres is accepted as the benefit assessment base along with each individual parcel's effective benefitted acreage, as provided in the attached enclosure, as the means for calculating each individual parcel's annual maintenance assessment.
4. For the purposes of the annual maintenance collection, a percentage of the permanent maintenance base is assessed to each individual parcel within Ditch No. 576 Tile's watershed as a rate per effective benefitted acre.
5. A maximum parcel charge of Thirty (30) dollars per effective benefitted acre and a minimum charge of ten (10) dollars per parcel.
6. In accordance with Ohio Revised Code 6137.112, an amount of \$72,000.00 is used in lieu of the original construction cost of Ditch No. 576 as the permanent maintenance base. The amount of \$72,000.00 reflects an estimated cost if Ditch No. 576 were to be constructed today.

7. Any parcel which has been, or will be, receiving a maintenance assessment reduction for the presence of a filter strip along the length of the maintained portion of Ditch No. 576, will have its assessment reduction calculated according to Resolution 10-1032 adopted on December 30, 2010.
8. In accordance with Ohio Revised Code 6137.06, Ditch No. 576 is to contribute a percentage of the total annual charges against the maintenance rotary fund equal to the percentage of Ditch No. 576's watershed acres within the total maintenance watershed acres of the maintenance program. The rotary fund is established to purchase equipment, materials, and labor related to the general maintenance of watercourses under Chapter 6137.

I also request that the changes to the permanent maintenance base and the benefit assessment base take effect and be certified to the Williams County Auditor upon adoption of the resolution.

Respectfully Submitted,

Brian D. Fritsch, P.E.
Williams County Drainage Engineer

encl

Parcel Number	Legal Acres	Watershed Acres	Effective Benefitted Acres	Updated Construction	Effective Benefit Percent	Owner	Owner Addr1	Owner Addr2	Owner City	Owner State	Owner Zip
07107000006000	40.00	29.14	22.30	\$1,447.80	2.01%	SCHMUCKER MICHAEL N AND	11328	COUNTY ROAD 1	EDON	OH	43518
07107000007000	60.00	56.29	40.99	\$2,661.74	3.70%	SCHMUCKER MICHAEL N AND	11328	COUNTY ROAD 1	EDON	OH	43518
07107000008000	80.00	19.75	15.23	\$988.63	1.37%	SCHMUCKER MENNO N AND	1559	COUNTY ROAD K	EDON	OH	43518
07107000008001	20.00	4.16	3.27	\$212.16	0.30%	SCHMUCKER MICHAEL N AND	11458	COUNTY ROAD I	EDON	OH	43518
07107000009000	40.00	6.70	4.70	\$305.08	0.42%	SCHWARTZ CLETUS E AND EVA	1839	COUNTY ROAD K	EDON	OH	43518
07117001003000	80.00	30.51	23.24	\$1,509.14	2.10%	VOLLMER KENNETH E TRUSTEE	2415	COUNTY ROAD K	EDON	OH	43518
07117001004000	80.00	41.21	31.66	\$2,055.62	2.86%	ROBERTS CHARLES E	10862	COUNTY ROAD 2	EDON	OH	43518
07117001005000	40.00	38.36	29.40	\$1,909.05	2.65%	VOLLMER KENNETH E TRUSTEE	2415	COUNTY ROAD K	EDON	OH	43518
07117001006000	35.12	3.24	2.53	\$164.16	0.23%	MEYERS LARRY	9450	COUNTY ROAD 2	EDON	OH	43518
07117001006002	2.00	0.53	0.34	\$22.36	0.03%	WEHRLE KREG D	10234	COUNTY ROAD 2	EDON	OH	43518
07117001006005	39.89	6.57	5.09	\$330.41	0.46%	WEHRLE DAVID A AND SANDRA	1240	STATE ROUTE 34	EDON	OH	43518
07118000001000	5.00	4.99	3.57	\$231.86	0.32%	CHRISMAN GARY W AND JAN L	1910	COUNTY ROAD K	EDON	OH	43518
07118000002000	5.00	5.00	3.08	\$200.13	0.28%	CHRISMAN GARY W AND JAN L	1910	COUNTY ROAD K	EDON	OH	43518
07118000003000	79.55	79.55	49.56	\$3,217.95	4.47%	SCHMUCKER MENNO N AND	1559	COUNTY ROAD K	EDON	OH	43518
07118000004000	78.87	78.87	57.52	\$3,735.09	5.19%	SWARTZ ELI I AND ROSA	1206	COUNTY ROAD K	EDON	OH	43518
07118000005000	79.14	79.14	59.41	\$3,857.68	5.36%	SCHMUCKER JOSEPH N &	10366	COUNTY ROAD 1	EDON	OH	43518
07118000006000	16.10	16.10	12.56	\$815.44	1.13%	SCHMUCKER JOSEPH N AND	10366	COUNTY ROAD 1	EDON	OH	43518
07118000007000	5.00	5.00	3.74	\$242.53	0.34%	FLEGAL SHAWN A	1185	STATE ROUTE 34	EDON	OH	43518
07118000007001	54.50	54.50	41.51	\$2,695.38	3.74%	MEYERS LARRY A & DEBROH S	9450	COUNTY ROAD 2	EDON	OH	43518
07118000008000	58.53	58.53	43.47	\$2,822.55	3.92%	COOK FAMILY FARMS LLC	10018	GREGG	FREDERICKT	OH	43019
07118000008001	1.97	1.97	1.30	\$84.42	0.12%	SHELINE NATHAN A AND	1531	STATE ROUTE 34	EDON	OH	43518
07118000009000	0.50	0.13	0.11	\$10.00	0.01%	THIEL TREVOR A	1883	STATE ROUTE 34	EDON	OH	43518
07118000010000	99.50	87.80	67.23	\$4,365.50	6.06%	LAUTZENHISER NIANN K	660	LN 210 HAMILTON LAKE	HAMILTON	IN	46742
07118000011000	60.00	60.00	44.69	\$2,901.98	4.03%	YOUNG WILLIAM H	207	HUNTINGTON	BRYAN	OH	43506
07118000012000	10.00	10.00	6.68	\$433.44	0.60%	CHRISMAN GARY W AND JAN L	1910	COUNTY ROAD K	EDON	OH	43518
07119000002000	75.50	21.90	16.30	\$1,058.16	1.47%	MEYERS LARRY	9450	COUNTY ROAD 2	EDON	OH	43518
07119000003000	50.00	45.76	30.35	\$1,970.68	2.74%	COOK FAMILY FARMS LLC	10018	GREGG	FREDERICKT	OH	43019
07119000004000	48.72	48.72	37.13	\$2,410.74	3.35%	MEYERS LARRY A AND	9450	COUNTY ROAD 2	EDON	OH	43518
07119000004001	6.02	6.02	4.02	\$261.02	0.36%	EMBERTON KATHY E AND STEVE	9562	COUNTY ROAD 1	EDON	OH	43518
07119000004002	3.00	3.00	1.65	\$106.86	0.15%	WEHRLE DAVID AND SANDRA	1240	STATE ROUTE 34	EDON	OH	43518
07119000004003	70.00	70.00	54.16	\$3,516.68	4.88%	WEHRLE SANDRA	1240	STATE ROUTE 34	EDON	OH	43518

Parcel Number	Legal Acres	Watershed Acres	Effective Benefitted Acres	Updated Construction	Effective Benefit Percent	Owner	Owner Addr1	Owner Addr2	Owner City	Owner State	Owner Zip
07119000005000	3.03	3.03	1.54	\$100.25	0.14%	BIGGER CHARLENE K	1038	STATE ROUTE 34	EDON	OH	43518
07119000006000	23.61	23.61	17.33	\$1,125.10	1.56%	LONGANBACH SCOTT D AND		PO BOX 39	EDON	OH	43518
07119000006001	13.39	13.39	9.85	\$639.74	0.89%	REV PROMOTIONS INC		PO BOX 39	EDON	OH	43518
07119000007000	5.10	5.10	3.24	\$210.34	0.29%	OSMUN DONALD AND DEBORAH	9236	COUNTY ROAD 1	EDON	OH	43518
07119000008000	5.07	5.07	3.09	\$200.39	0.28%	SMITH RALPH F AND		PO BOX 11	EDON	OH	43518
07119000009000	5.07	5.07	3.09	\$200.44	0.28%	SCHOOLEY TYLER R	9110	COUNTY ROAD 1	EDON	OH	43518
07119000010000	5.00	5.00	3.07	\$199.18	0.28%	WEHRLE EDWIN L AND	1045	COUNTY ROAD I	EDON	OH	43518
07119000011000	5.00	5.00	2.97	\$192.90	0.27%	DIEHL THOMAS J AND	1121	COUNTY ROAD I	EDON	OH	43518
07119000012000	137.26	137.24	52.43	\$3,404.17	4.73%	VOLLMER KENNETH E TRUSTEE	2415	COUNTY ROAD K	EDON	OH	43518
07119000013000	1.81	1.81	1.32	\$85.64	0.12%	JACKSON HERBERT AND	1603	COUNTY ROAD I	EDON	OH	43518
07119000014000	78.16	31.37	23.68	\$1,537.87	2.14%	PERSON DANIEL RAY AND	5950	TERRITORIAL	CAMDEN	MI	49232
07119000015000	1.84	0.47	0.38	\$24.49	0.03%	LLOYD LARRY G AND	9345	COUNTY ROAD 2	EDON	OH	43518
07120006001000	1.00	1.00	0.73	\$47.27	0.07%	DARGITZ EUGENE AND CAROLYN	9540	COUNTY ROAD 2	EDON	OH	43518
07120006002000	158.23	117.56	91.35	\$5,931.70	8.24%	MEYERS LARRY AND DEBROH J/S	9450	COUNTY ROAD 2	EDON	OH	43518
07120006007000	71.41	7.97	6.21	\$403.41	0.56%	WEHRLE DAVID AND SANDRA J/S	1240	STATE ROUTE 34	EDON	OH	43518
07120006009000	15.22	1.05	0.82	\$53.08	0.07%	VICTORY 1 PROPERTIES LLC		PO BOX 39	EDON	OH	43518
07120006009005	15.31	11.10	8.66	\$562.25	0.78%	MEYERS LARRY AND DEBROH J/S	9450	COUNTY ROAD 2	EDON	OH	43518
07120006012000	9.78	2.04	1.59	\$103.35	0.14%	EDON FARMERS CO OP		PO BOX 308	EDON	OH	43518
07120006013000	2.76	2.75	2.15	\$139.43	0.19%	MEYERS LARRY AND DEBROH J/S	9450	COUNTY ROAD 2	EDON	OH	43518
07130000001000	40.00	1.36	1.06	\$68.88	0.10%	TRAUSCH MICHAEL F AND	7214	COUNTY ROAD J	EDON	OH	43518
07130000002000	38.18	38.09	27.77	\$1,803.38	2.51%	RUNYAN PHYLLIS M	1648	COUNTY ROAD I	EDON	OH	43518
07130000002001	1.82	1.32	1.00	\$64.85	0.09%	RUNYAN TODD AND ANGIE	1680	COUNTY ROAD I	EDON	OH	43518
07130000003000	47.50	47.50	34.37	\$2,231.89	3.10%	MILLER DOYLE AND	1302	COUNTY ROAD I	EDON	OH	43518
07130000004000	67.50	57.73	43.74	\$2,840.31	3.95%	WEHRLE KREG AND TRISTA	10234	COUNTY ROAD 2	EDON	OH	43518
07130000010000	80.00	21.35	16.00	\$1,039.10	1.44%	TRAUSCH MICHAEL F AND	7214	COUNTY ROAD J	EDON	OH	43518
County	2716.71	4.95	4.42	\$286.96	0.40%	WILLIAMS COUNTY ENGINEER					
Florence Township	223.09	14.03	12.52	\$812.97	1.13%	FLORENCE TWP TRUSTEES					
Indiana Northeast	99.22	10.59	9.45	\$613.90	0.85%	INDIANA NORTH EASTERN RR			HILLSDALE	MI	49242
ODOT	1501.60	5.20	5.10	\$330.90	0.46%	ODOT					
Steuben County	9.97	3.48	3.11	\$201.62	0.28%	STEBEN COUNTY INDIANA					
	6707.56	1558.69	1108.77	\$72,000.00	100.00%						

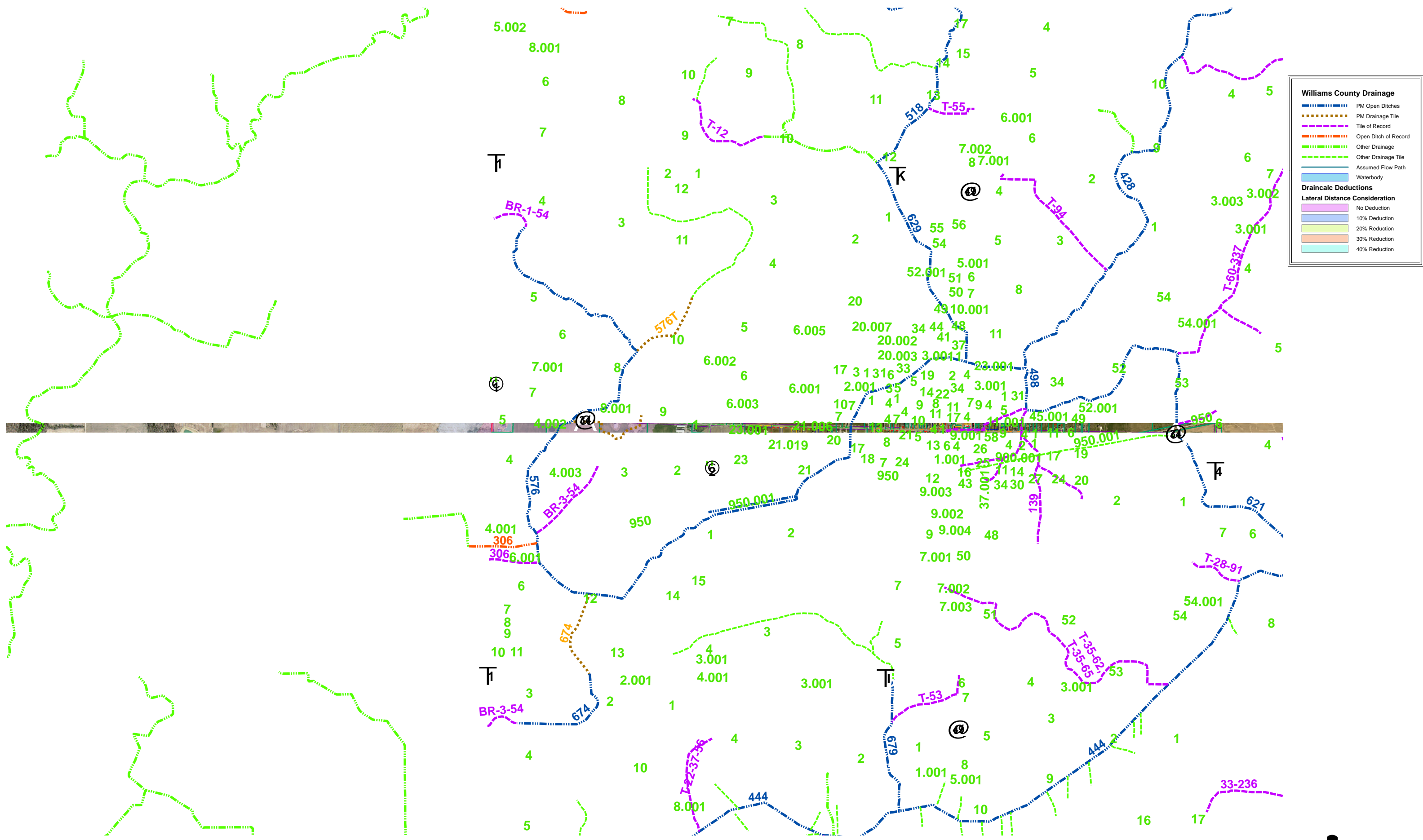

Williams County Drainage

- PM Open Ditches
- PM Drainage Tile
- Tile of Record
- Open Ditch of Record
- Other Drainage
- Other Drainage Tile
- Assumed Flow Path
- Waterbody

Lateral Distance Consideration

- No Deduction
- 10% Deduction
- 20% Deduction
- 30% Deduction
- 40% Deduction

576 Lautzenhiser

